



The SADL is a keyless solenoid controlled Lock that locks and unlocks dependent upon the signal received from the Salvo Control Panel (SCP). The unit incorporates a locking bolt which passes through the door running rail and into the lock body. Only when the signal is received from the SCP, can the locking bolt be disengaged, allowing the door to be opened.

Operation

The SADL is a keyless solenoid controlled lock that locks and unlocks dependant on the signal received from the SCP unit. When the SGL is fitted to a truck the key is released and is then taken to be inserted into the SCP. Once inserted and turned it will send a signal to the SADL illuminating the green LED and electromechanically allowing the removal of the bolt, this therefore allows the opening of the dock door or a chain barrier. When the bolt is removed, a yellow light illuminates indicating that access has been granted and will also send a signal back to the SCP locking the key in its panel, this prevents the removal of the permit key while loading is granted.

Precautions



Installation should be carried out by a qualified electrician. Please retain this document.

Wiring Instructions

Electrical Connection - Refer to Salvo Control Panel Wiring Diagram.

Installation

Fixing Instructions

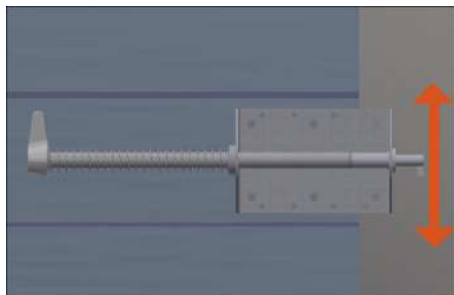

Step 01: First ensure the door is fully closed. Determine the position of the locking bolt to ensure that either parts do not clash with existing door fixings. Suggested height between 1.5m and 2m from floor level.

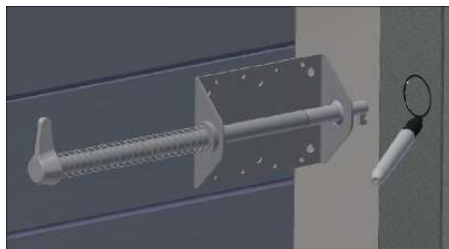

Step 02: Mark the position of the bolt clearance hole on the inside of the door running guide. Check that the lock and bolt do not clash with bay controls.



Step 03: Drill the clearance hole in the running guide using a 28mm tank cutter.



Step 04: Determine the position of the lock door, ensuring that the bolt entry hole aligns. Use the hole in the door running guide to align the lock.



Step 05: Use the hole in the door running guide to align the lock.

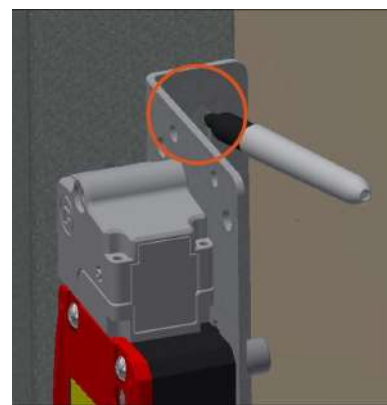

Step 06: Mark and drill the positions of the mounting bracket holes.



Step 07: Fix the lock and bracket in place with the screws provided.

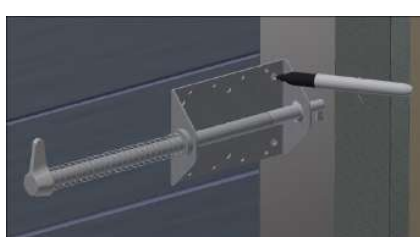

Step 08: With the door fully closed, engage the bolt into the lock body, through the previously drilled hole in the door running guide. Mark the positions of the fixing holes in the door.



Step 09: Drill holes and fix in place using bolts, washers and nuts supplied. Trim excess bolt length if necessary.

Specifications

Bolt Material	Stainless steel
Housing Material	Zink alloy to BS EN 12844
Finish	Red Polyester Powder Coat
Ingress Protection	IP67
Operating Force	0,5Nm
Retention Force - Locked	2500N
Max. Approach Speed	20M/min
Mechanical Life	>1,000,000 Switching Cycles
Max. Frequency of Operation	7,200/hour
Ambient Temperature	-5°C to 40°C (Mean over 24 hours = 35°C)
Max. Wire Cross Section to fit Connector	2,5mm ²
Connector Type	Spring Activated Vibration Proof Block
Switch Conformance	DIN VDE 0660 Part 206 & IEC
Switching	Positive Break
Switching Control	3A
Switching Voltage	230V AC max
Isolating Distance	2x2mm per Switch Element
Contact Material	24VAC/VDC

Maintenance Instructions

Under normal operating conditions very little maintenance is required. If used in dusty conditions, blowing out with compressed air will prevent a build up of sediment in the locks.

Under no circumstances, however, should the locks be oiled or greased as this causes the locks to clog and malfunction. All locking systems should be checked regularly for correct operation, security of fixings and condition of keys etc. The function of all keys that should be trapped must be checked under operating conditions, as should the ease of removal of released keys. In the event of malfunction, evident wear or damage, parts should be replaced or returned to Castell for repair if appropriate.

Users of interlock systems have a duty under Section 2 of the Health and Safety at Work etc Act 1974 to ensure that the systems are correctly installed and maintained in a satisfactory condition.

Order Information

Please advise correct part number when ordering.

(mandatory information)**

Part Number**	Description
006479/1	Hand 1
006479/2	Hand 2
007051	With Chain Kit

